

FRAMELESS PARTITION

TP

Lite

TP

Lite

FACTS ABOUT TP LITE

- TP Lite is a frameless fully glazed partition system with a single glass layer
- TP Lite with door frames ensures sound reduction that meets normal sound demands for meeting rooms
- The glass is fixed by runners at the floor and top and the glasses are joined vertically using a dry silicone tape.
- Choose between glazed or wooden door leaves in a T shaped door frame. Or glazed doors without a door frame.

triplan.net | T.: +45 4353 9999 | info@triplan.net

1. WALL TYPES

Glass for TP Lite is safety glass in at least 10 mm thickness with polished vertical edges and chamfered upper and lower edges.

For the selection of glass type please consider:

- Safety level
- Wall height
- Demands to sound reduction

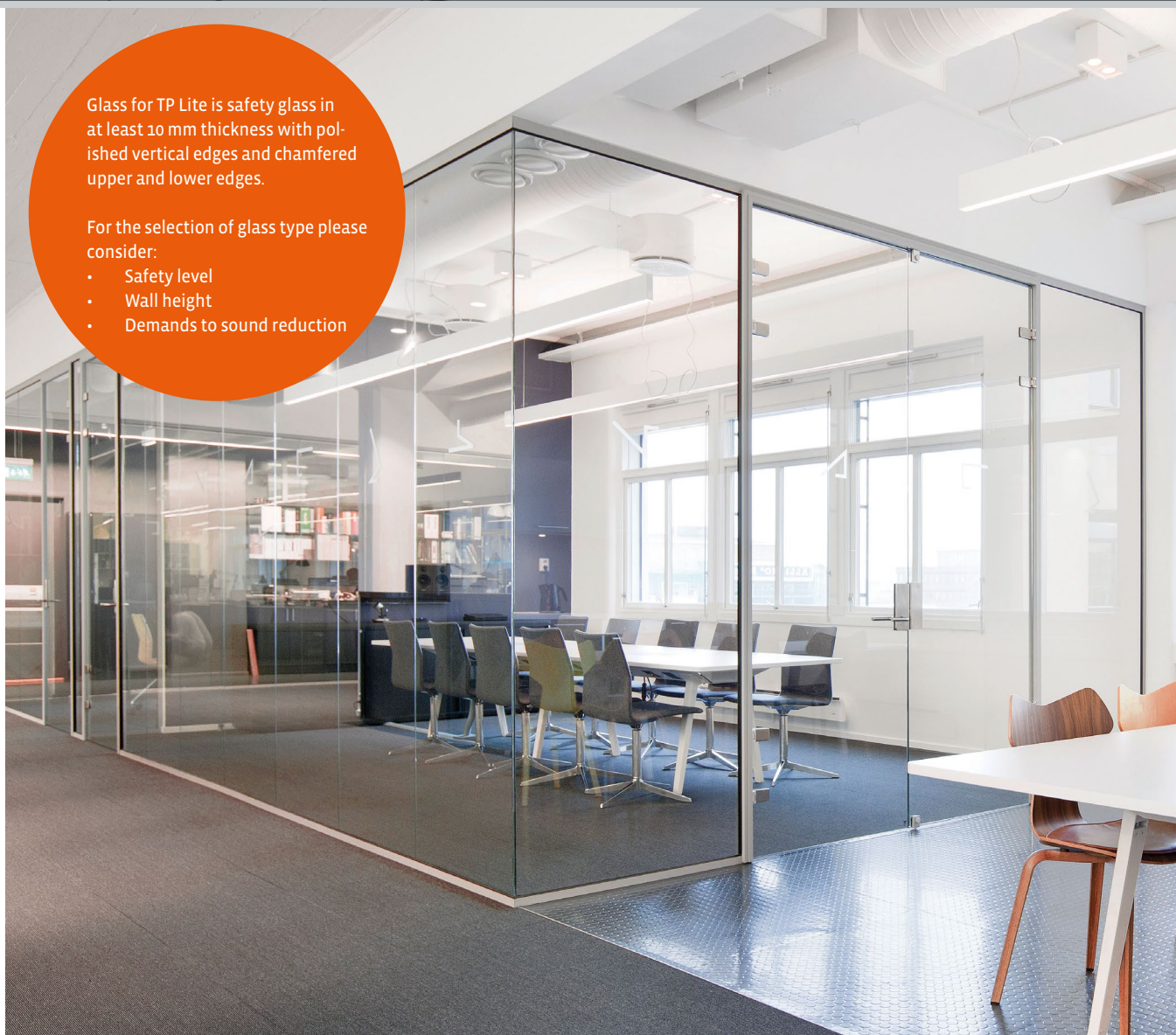

Glass type	Weight glass kg/m ²	Sound reduction for glass
Hardened clear float glass:		
10 mm	25	Rw 34dB
12 mm	30	Rw 35 dB
15 mm	37.5	Rw 37 dB*
Laminated glass:		
10.76 mm	25	Rw 35 dB
12.76 mm	30	Rw 36 dB
16.76 mm	37.5	Rw 39 dB
Laminated sound glass:		
10.76 mm	25	Rw 38 dB
12.76 mm	30	Rw 40 dB
16.76 mm	37.5	Rw 42 dB

*Calculated value

Consult furthermore the directions issued by the Glass industry on **Fully glazed interior partitions - Choice of glass for interior partitions**
Datasheet for **hardened glass DS/EN 12150**
Datasheet for **laminated glass DS/EN 14449**

2. DOOR TYPES (T-FRAME)



Doors are 40 mm solid wooden doors or 10 mm hardened glass doors with a T-frame in aluminium.

Standard doors are M9 but also available in M10 and in full height (contact Triplan A/S).

Doors are single or double doors with or without glass above.

Wooden doors are with Assa Abloy pin hinges. Lock case to be agreed upon. Door colour NCS 0502Y or special colour.

Glass doors with 2 glass hinges or pivot hinges and Triplan TP 565 stainless steel lock case or Studio alu lock case.

Doors come optionally with a floor seal.

Door frames are aluminium, anodized or powder coated RAL 9010. Door frames are optionally available in a special colour.

DOOR SOLUTIONS

See detail drawings at triplan.net

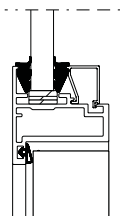

Vertical section
Solid door with glass above

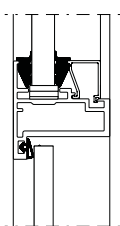

Vertical section
Glass door with glass

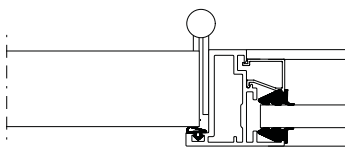

Horizontal section solid door

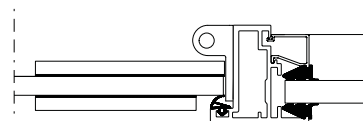

Horizontal section glass door

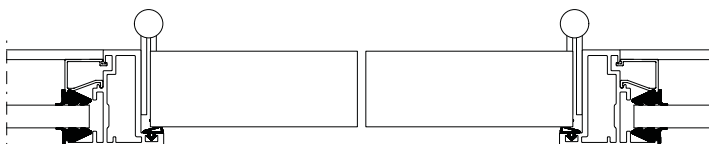

Horizontal section double solid door

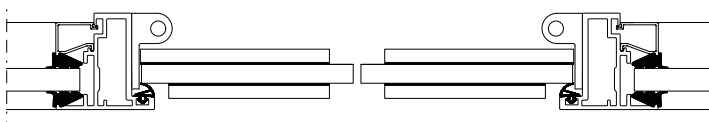

Horizontal section double glass door

Door type	Doorleaf thickness (mm)	Sound reduction in a 12.76 mm glass wall
Glass door	10	Rw 28 dB*
Glass door with floor seal	10	Rw 35 dB*
Solid door	40	Rw 28 dB**
Solid door with floor seal	40	Rw 34 dB*
Solid door 35 dB	40	Rw 37 dB*

*Laboratory measured values

**Calculated value

3. JOINTS



Joints in glass partition or corners are as standard done with a 2 mm double-sided adhesive dry silicone tape. Optionally a 5 mm wet silicone joint.

JOINTS

See detail drawings at triplan.net

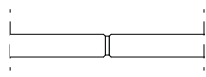

Horizontal section.
Module joint.
2 mm dry silicone tape.

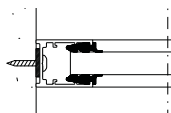

Horizontal section
Start.
U-section 30 mm.

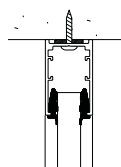

Vertical section
Top detail.
U-runner 30/40/60 mm.

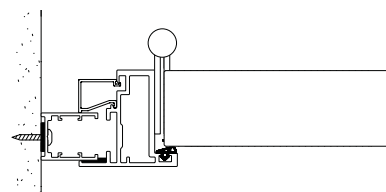

Horizontal section
Door detail.
Runner 30 mm.

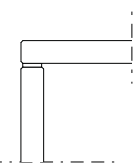

Horizontal section.
Corner joint.
2 mm dry silicone tape.

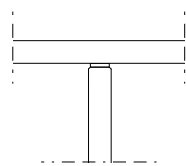

Horizontal section.
T-joint.
2 mm dry silicone tape.

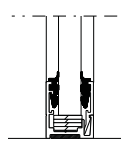

Vertical section.
Floor detail.
U-runner with click-on section.

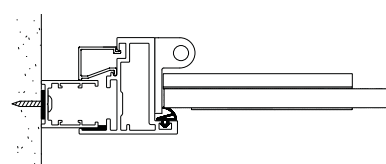

Horizontal section
Start.
U-runner 30 mm.

Upon jointing to existing walls please foresee:

- 1) Runners
- 2) Rubber gaskets
- 3) Acoustic tape

1) Runners are 25/30 mm wide aluminium runners, anodized or powder coated RAL 9010. Runners optionally available in special colour.

2) Rubber gaskets are black in various thicknesses depending on the choice of glass.

3) Acoustic tape is 3x14 mm in rolls that are glued on the runners for sound insulation towards existing room elements.

4. SPECIAL SOLUTIONS/ACCESSORIES

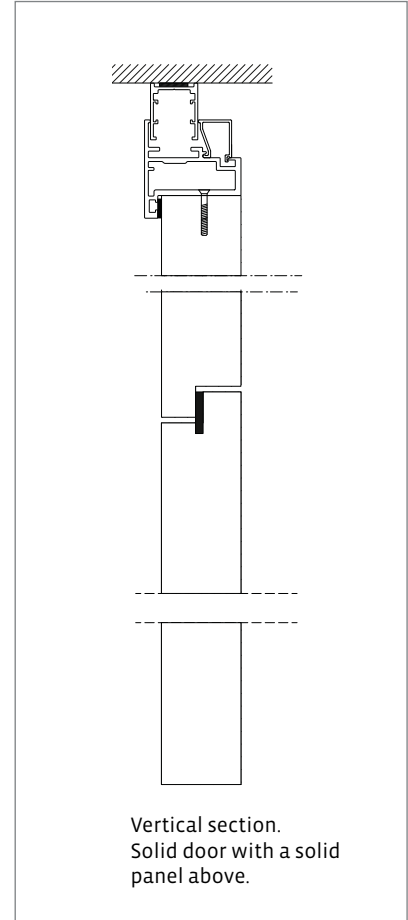

DOORS WITH REBATED OVER PANELS

TP Lite also offers solid doors with a solid panel above or solid panels next to the door. The T-frames may optionally be produced in timber. Side panels are often used for switches, sockets and cabling.

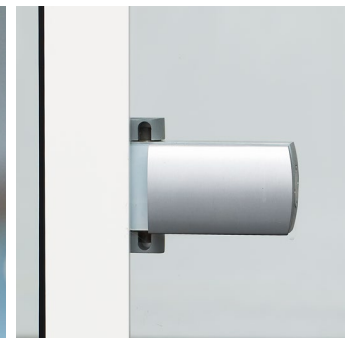
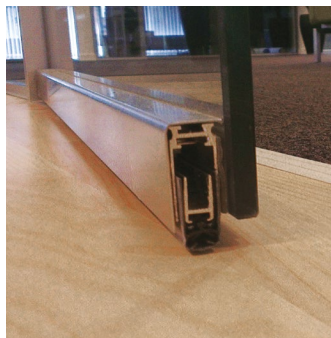

ACCESSORIES

The TP Lite glass wall can be combined with different types of doors, frames, hinges and lock cases. Standard is TP 565 lock case or Studio lock case and solid stainless steel hinges for glass doors.

Optionally lock case for electric strike plate and hinges with oil hydraulic self closing function.

Both solid doors and glass doors may optionally come with floor seal.

5. PIVOT HUNG DOORS



TP Lite is optionally available with glass doors without door frames.

Doors are available as single or double doors with or without glass above.

Standard doors are M9x21. Optionally M10 and in full height (contact Triplan A/S).

Glass doors are fixed at top and base and with a runner above that hides the pivot mechanism. Glass doors with glass above come with a corner patch fitting for pivots.

Glass doors are 10 mm hardened glass doors with 2 x hinges or pivot hinges and corner patch fitting in aluminium.

Also available as double doors.

PIVOT HUNG DOORS

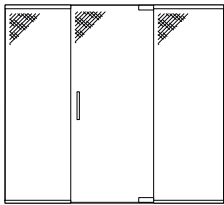

Pivot hung glass door

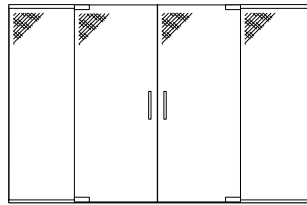

Pivot hung double glass door

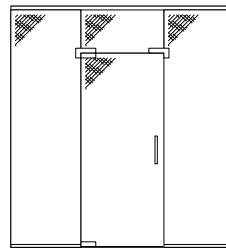

Pivot hung glass door with glass above

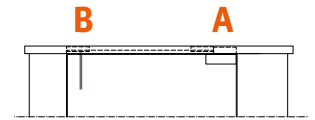

Pivot hung glass door TP Lite head detail TP24

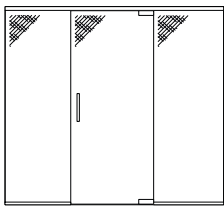

Pivot hung glass door with head runner (TP24)

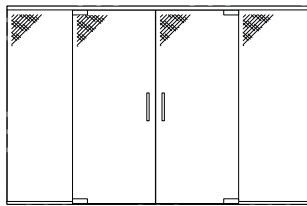

Pivot hung double glass door with head runner (TP24)

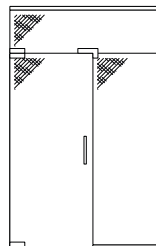

Pivot hung glass door towards a wall, with glass above

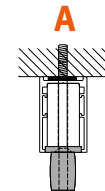

Vertical section. Head detail. Corner patch fitting. Pivot hung glass door

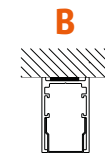

Vertical section. Head runner with cover section in the door opening.

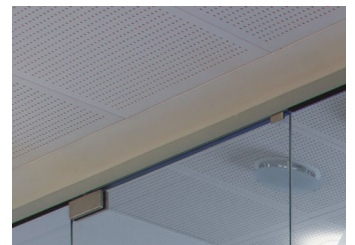

6. SLIDING DOORS

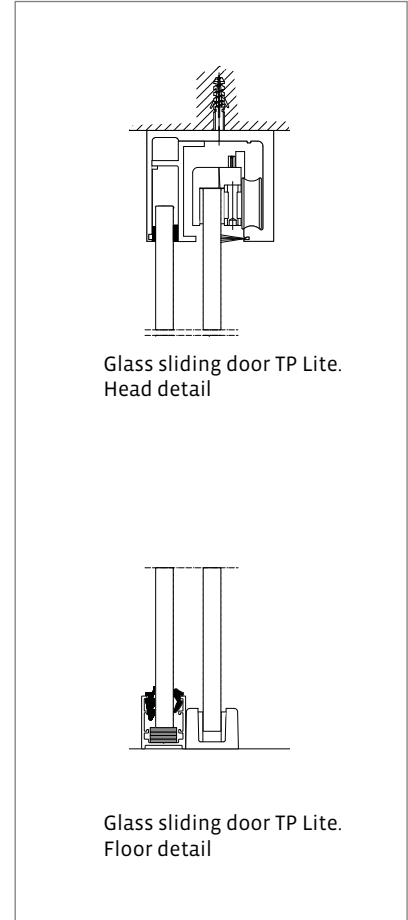

SLIDING DOORS

Triplan also supply TP Lite with glass sliding doors.

Joints in glass partition or corner near sliding doors are foreseen with 2 mm open joints. Optionally with 2 mm double-sided dry silicone tape or with 5 mm wet silicone joint. Triplan glass sliding doors can also be fitted on glass above the opening.



TP LITE

– Fully glazed wall

- A simple and elegant design
- Easy to assemble
- Short delivery time for standard solutions
- Triplan standard components
- Flexible and quick door frame assembly
- It is possible to replace the door frame if the end user may one day wish to change a glass door into a wooden door or vice versa.
- Provided that the same module width for door and glass is selected, the door can easily be moved.

Read
more at
triplan.net

OPERATION AND MAINTENANCE

Glass: **Cleaning for the first time:**
Glass delivered from Triplan A/S has been washed, but not polished. Can be wiped off with a weak ammonium chloride solution followed by washing with clean water and drying with a dry cloth.

Ongoing cleaning:
Glass should be washed as needed using a suitable cleaning agent and polished with a soft cloth. Use clean water and equipment to avoid scratches.

Doors: Door surfaces and frames are cleaned by wiping them with a moistened cloth, wrung with a weak solution of water and ordinary cleaning agent. Avoid cleaning agents containing alcohol, solvents, chlorine or ammonium chloride. Hinges and lock cases should be lubricated as needed, but at least once a year.

Runners: Sections and sealing tape should be cleaned by wiping them with a moistened cloth wrung with a weak solution of water and ordinary cleaning agent. Avoid cleaning agents containing alcohol, solvents, chlorine or ammonium chloride.



The TP system also includes

TP Lite Twin

TP Acoustic

TP Fire

TP Fire Lite