

STEEL FRAMED GLASS FRONTS EI60

Mounting instruction

It is of great importance for the door's fire and/or acoustic performance that it is mounted in the proper way.







The person(s) who perform the installation are responsible for the door being installed as specified in this instruction.

The formal approval of the supplied items is not in force if the installation deviates from this instruction.

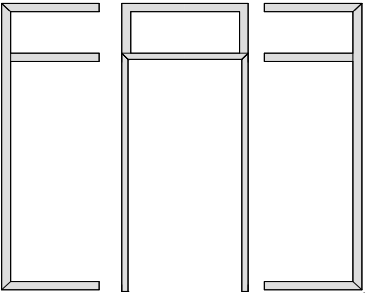
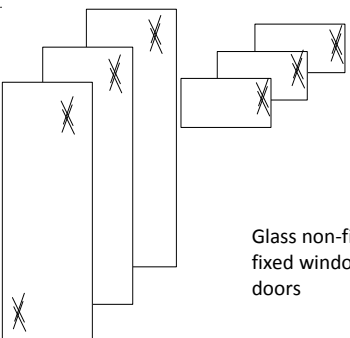
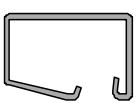
Index:

1. Component outline
2. Control upon receipt and starting up
3. Mounting of glass front/door in wall opening
4. Insertion of levelling,-and support inserts
5. Insertion of glass and rubber gaskets

1. Component outline

 <p>Steel frames: - frames for fixed side lites - door frame incl. matching door leaf frame.</p> <p>Steel frames are pre-fitted with buttons for clicking on U-sections</p>		 <p>Glass non-fitted, for fixed windows and doors</p>	
 <p>U-section</p>	 <p>* Remove before fitting</p> <p>Rubber bead</p>	 <p>Rubber gasket next to u-section</p>	 <p>Self adhesive rubber gasket next to rebate</p>
 <p>Support inserts 6x39x80 mm</p>	 <p>levelling inserts 2.5x24x80 mm location: groove in rebate</p>	 <p>Adjusting inserts: 1.5/2.5x24x80 or 1.5/2.5/3x39x80 mm</p>	

2. Control upon receipt and starting up

NOTE! You need to consult the detailed project drawings during the mounting.

Verify that the goods that you have received have not been damaged during transport and that there is harmony between the order confirmation and the supplied goods.

Measure the opening and verify that this dimension matches the specific project from Triplan.

3. Mounting of glass front/door in wall opening

Door frame / the frames for the fixed side lites are erected in the wall opening and secured with wedges vertically and horizontally to the surrounding brick wall or dry wall.

Once the elements are in spirit level and once the door leaf is placed correct in terms of verifying that the door does not scratch the floor when opening to 90/180°, then you proceed with the final fixation of the entire element. For this purpose use the pre-drilled holes in the side frames and in the upper frame (fig.3).

The joint between the frame and brick wall/dry wall/floor must be 5-20 mm. The joints must be filled with mineral wool - fig. 3 and 4. The mineral wool may optionally be sealed with elastic joint sealant on both sides.

Gap between door leaf and floor is 8 mm - fig. 1 and 2.

Fixation screws and jointing material are not included in Triplan's supply.

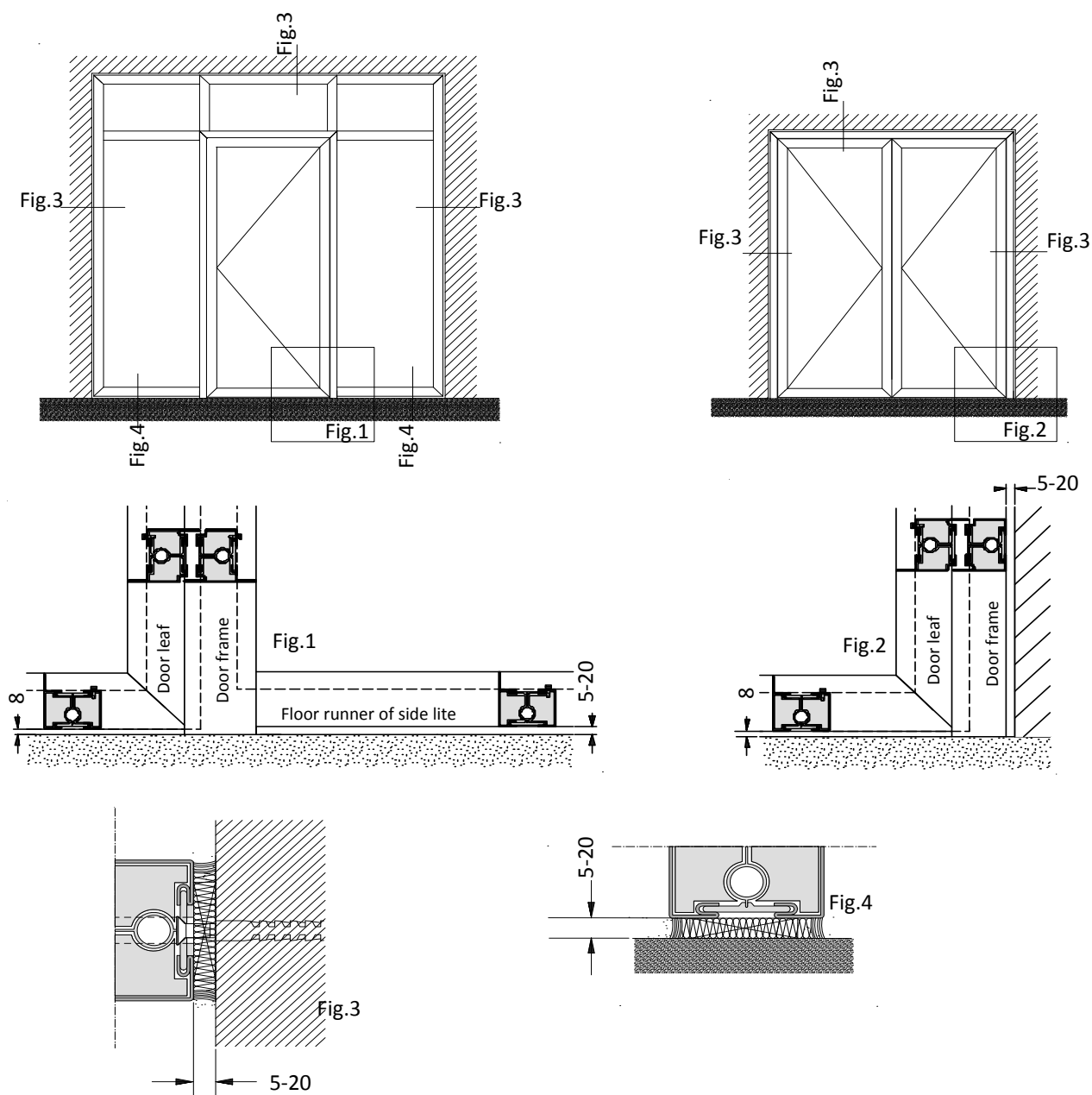

4. Insertion of levelling,-and support inserts

After the fixation of the door frames and/or the glasframes it is time to fit the levelling inserts and the support inserts (set 1) - see figure 5 + 6.

In order to level out the foundation for the support inserts it is necessary to place levelling inserts in the countersink of the rebate (2 pieces per glass and 3 pieces per door of which 1 piece at the top of the strike plate side (*)) as illustrated on below drawings. In order to allow this **you must remove** matching area (80mm) of the fire resistant laminate - fig. 7.

The levelling and support inserts are placed as shown on fig.8 + 9. On the vertical door frame (*) the inserts must be fitted using wet silicone.

The levelling inserts must be placed/fixed at least 56 mm from the end of the rebate.

Self adhesive rubber gaskets must be glued to the rebate - fig. 10

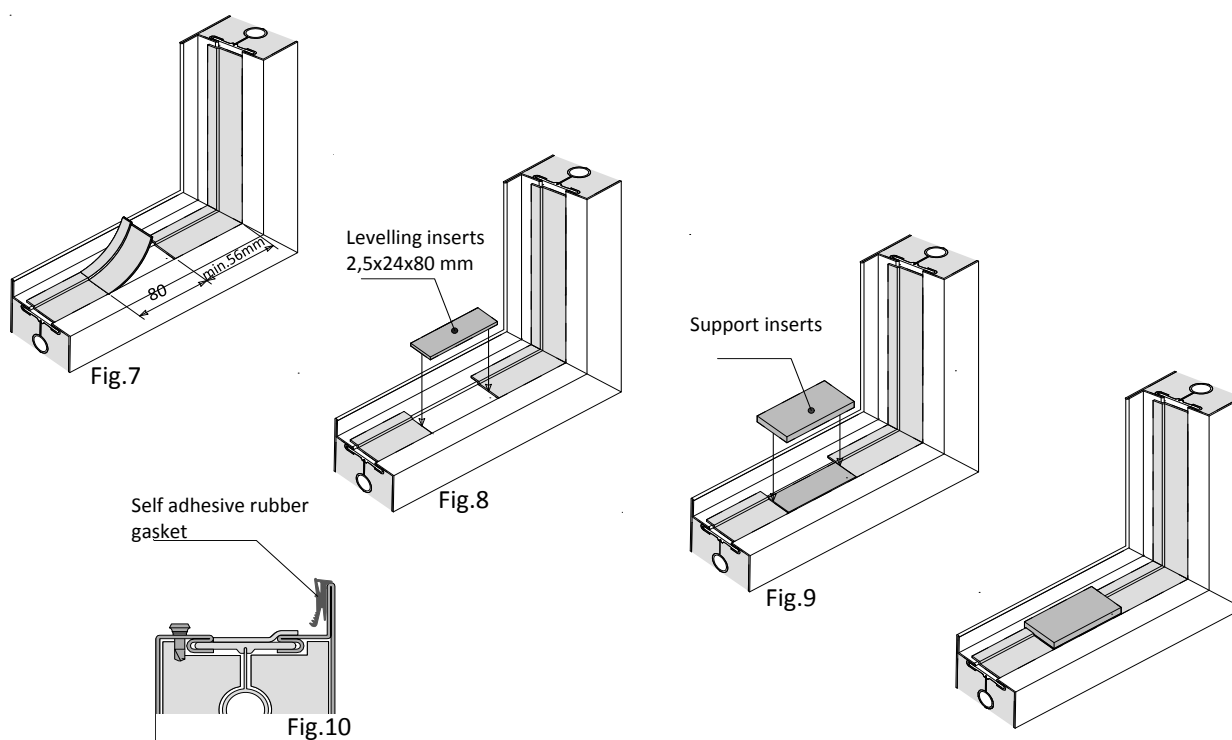
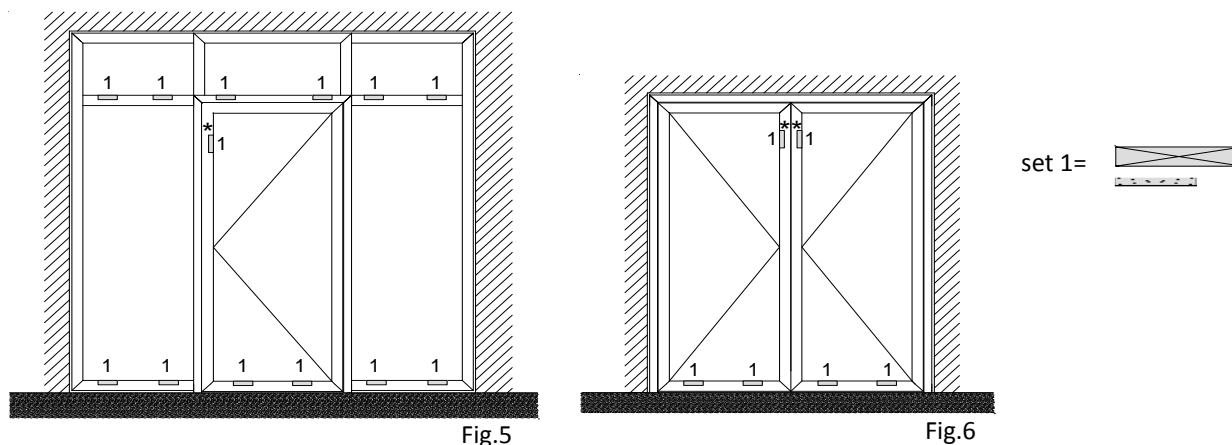

5. Insertion of glass and rubber gaskets

Once the steel frames have been fitted with levelling and support inserts (set 1) and the selfadhesive rubbergasket has been fitted it is now time to fit the glass.

The glass is placed on the support inserts and adjusted to it's perfect place (fig.13) which is when there is equal amount of air (7 mm) on all 4 sides. Next mount inserts at the top of the door and the back of the door (set 2), fig.11 + 12.

Now click on the metal u-sections and insert the the rubber gaskets - fig.14.
Soapwater may ease the insertion of the rubber gaskets.

Fit rubber gaskets on the doors and door frame. Remove a strip from the rubber gasket - fig.15.

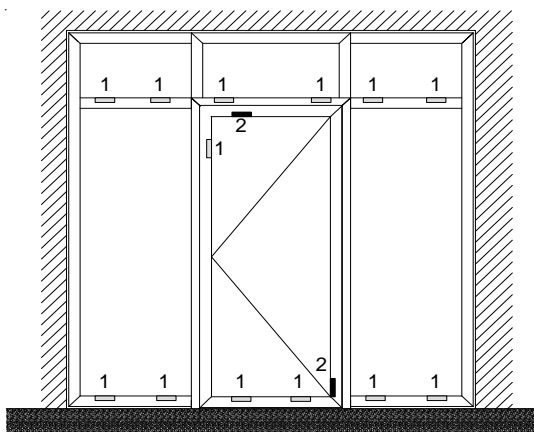

Fig.11

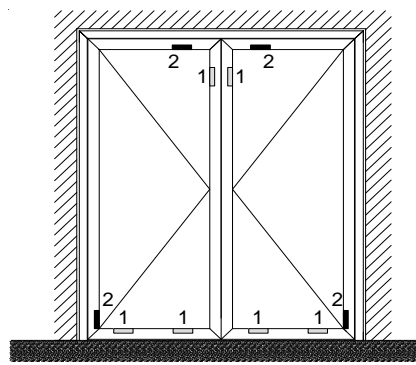

Fig.12

set 1=

set 2=

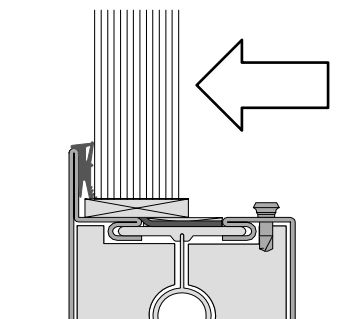

Fig.13

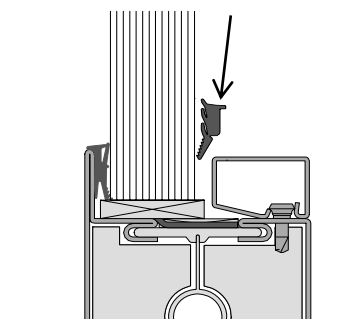

Fig.14

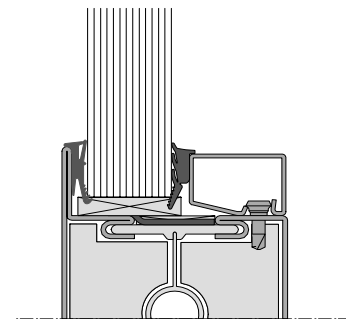

Fig.15