

TRIPLAN NEW YORK®

GLAZED WALL SYSTEM

GLAZED WALL SYSTEM WITH TRANSOMS

NEW YORK

TRIPLAN NEW YORK®

GLAZED WALL WITH TRANSOMS

- The TRIPLAN NEW YORK® - glazed wall system with transoms consists of a single glass layer from floor to ceiling that is fixed at the top, base and sides by slim sections.
- The glasses are joined vertically using a dry silicone tape. The transoms are fitted afterwards using vertical and horizontal sections. The positions of the transoms are designed to suit each individual project.
- For general information on TRIPLAN NEW YORK® please refer to the product brochure or web site triplan.net

JUNCTIONS

See detail drawings on our website triplan.net

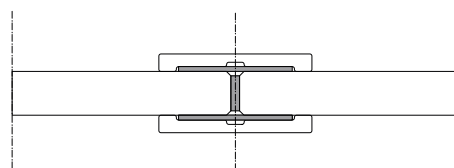

Horizontal section.
Vertical module joint.
Transom 35 mm.

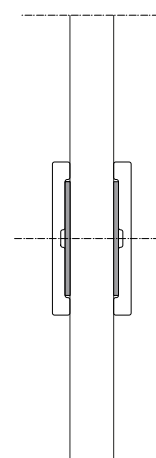

Vertical section.
Horizontal module joint.
Transom 35 mm.

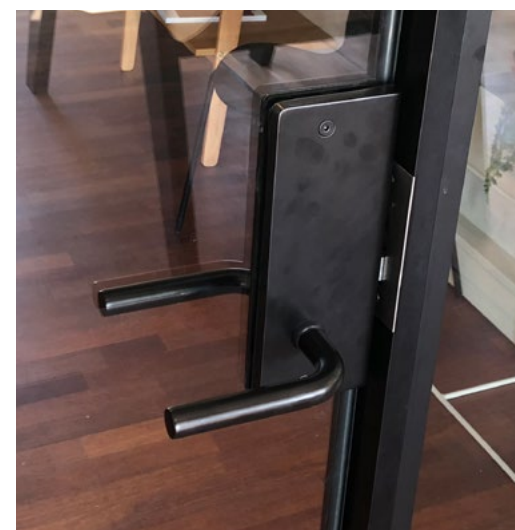
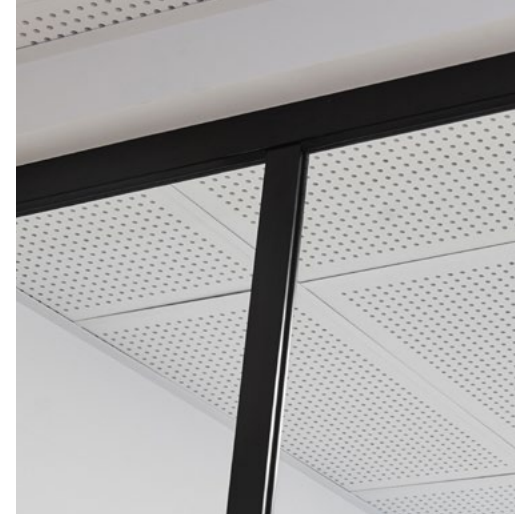



TRIPPLAN
NEW YORK

pla
NEW YORK

TRIPPLAN LITK
NEW YORK



TRIPLAN
NEW YORK











TRIPLAN NEW YORK®

TRIPLAN NEW YORK® is a further development of TRIPLAN LITE®, a glazed wall system in a simple design with many abilities.

TRIPLAN NEW YORK® is equipped with vertical and horizontal transoms that are taped onto the glass thus transforming it into the popular New York look.

An elegant solution with an industrial touch that is easy to install.

With a TRIPLAN NEW YORK® glazed wall you maintain transparency, openness and flexibility in the design using an aesthetic and simple solution.

TRIPLAN NEW YORK® is produced as a standardized glazed wall system at Triplan's own factory and it's therefore quickly supplied. At the same time it's easy to adjust individually so that you can have a customised solution that suits your project.

TRIPLAN NEWYORK® FITTING OF TRANSOMS

- For a TRIPLAN LITE® installation guide, please refer to triplan.net

TRIPLAN LITE® can after completed installation be equipped with vertical and horizontal transoms that are taped onto the glass thus transforming it into the popular New York look. Please observe that the vertical transoms with yellow tape are fitted first, next the horizontal transoms with blue tape are fitted in between the vertical transoms and the side sections.

1. Clean the glass to remove grease and dust.
2. Vertical transoms are cut to length and taped between the upper runners and floor runners.
3. The rubber gasket is cut to give way for the transom in order for the transom joins with the head and base runners. Illustration 11-12.
4. Horizontal transoms are cut to size and are taped between the vertical transoms and the side sections. Illustration 13.

