

TRIPLAN LITE[®]

WITH TRANSOMS

TRIPLAN LITE

WITH TRANSOMS - THE NEW YORK WALL

TRIPLAN LITE[®]

WITH TRANSOMS

- The TRIPLAN LITE[®] - glazed wall system with transoms consists of a single glass layer from floor to ceiling that is fixed at the top, base and sides by slim sections.
- The glasses are joined vertically using a dry silicone tape. The transoms are fitted afterwards using vertical and horizontal sections. The positions of the transoms are designed to suit each individual project.
- For general information on TRIPLAN LITE[®] please refer to the product brochure or web site triplan.net

JUNCTIONS

See detail drawings at
triplan.net

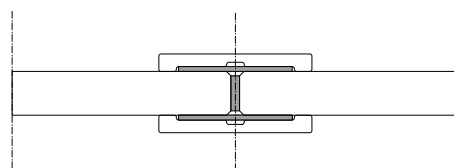

Horizontal section.
Vertical junction.
Transom 35 mm.

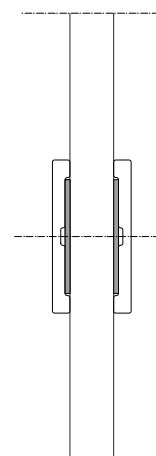

Vertical section.
Horizontal junction.
Transom 35 mm.













TRIPLAN LITE®

THE COMPLETE GLAZED PARTITIONING SYSTEM

TRIPLAN LITE® is a glazed wall system in a simple design with many abilities.

With a TRIPLAN LITE® glazed wall you maintain transparency, openness and flexibility in the design using an aesthetical and simple solution. It also provides a solution for projects with extra high demands as to sound insulation or fire resistance.

Triplan has developed the system with the aim of being able to offer a similar design with runners of equal height and finish – and you are able to select very different performances.

Whether you need a basic glazed partitioning wall, a meeting room with high demands to sound insulation or a fire rated glazed partition you can find a solution with TRIPLAN LITE®. Without making a compromise as to the light design with slim runners at head and base and the light doorframes for glazed- or wooden doors.

TRIPLAN LITE® is produced as a standardized glazed wall system at Triplan's own factory and it's therefore quickly supplied. At the same time it's easy to adjust individually so that you can have a customised solution that suits your project.



FITTING OF TRANSOMS

- For a TRIPLAN LITE® installation guide, please refer to triplan.net

TRIPLAN LITE® can after completed installation be equipped with vertical and horizontal transoms that are taped onto the glass thus transforming it into the popular New York look. Please observe that the vertical transoms with yellow tape are fitted first, next the horizontal transoms with blue tape are fitted in between the vertical transoms and the side sections.

1. Clean the glass to remove grease and dust.
2. Vertical transoms are cut to length and taped between the upper runners and floor runners.
3. The rubber gasket is cut to give way for the transom in order for the transom joins with the head and base runners. Illustration 11-12.
4. Horizontal transoms are cut to size and are taped between the vertical transoms and the side sections. Illustration 13.

